

INSTALLATION INSTRUCTIONS

69-4516 CHEVROLET 2005 COBALT SS 2.0L Supercharged

TOOLS NEEDED:

Flat Blade Screwdriver
Phillips Blade Screwdriver
Pliers
Ratchet
Extension
10mm Socket
9/32 Socket
5/16 Socket
3mm allen key

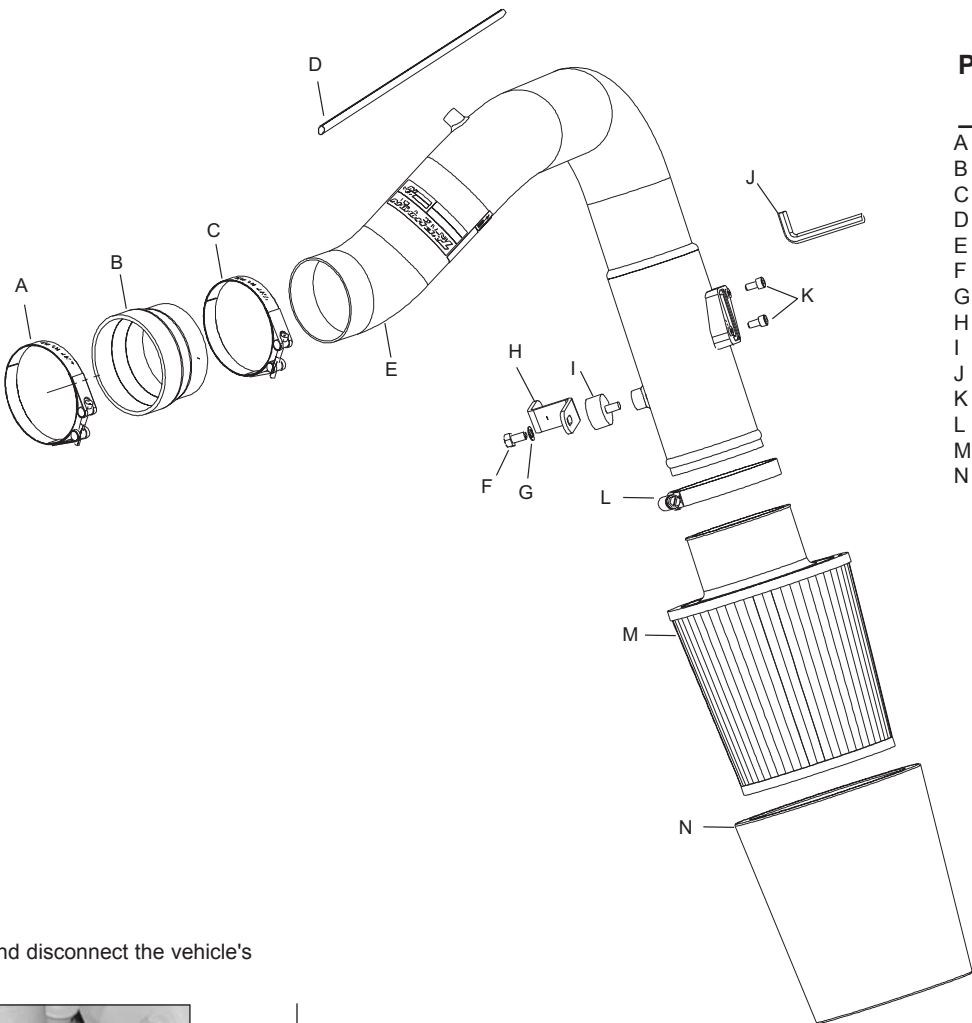

PARTS LIST:

Desc.	Qty.	Part #
A HOSE CLAMP; #325V, BARREL, SS	1	084063
B HOSE; 2-3/4" TO 3" X 2"L, SILC, BLACK	1	084036
C HOSE CLAMP; #300V, BARREL, SS	1	084062
D EDGE TRIM; 1/16"GAP, 32"L	1	102456
E INTAKE TUBE	1	27507TS
F BOLT; 6MM-1.00 X 12MM HEX	1	07863
G WASHER; 6MM WAVE, SS	1	08277
H BRACKET; 69-6543, "Z", STL, FB/PC	1	010033
I STUD; RUBBER MNT,1/2"L X 1"W	1	070228
J WRENCH; 9/64 SHORT ALLEN KEY	1	69802
K BOLT; M4 - 0.07 8MM, A/H CAP, SS	2	07733
L HOSE CLAMP #48	1	08601
M FILTER	1	KRU4990E
N DRYCHARGER WRAP, BLACK	1	971001DK

TO START:

1. Turn the ignition OFF and disconnect the vehicle's negative battery cable.

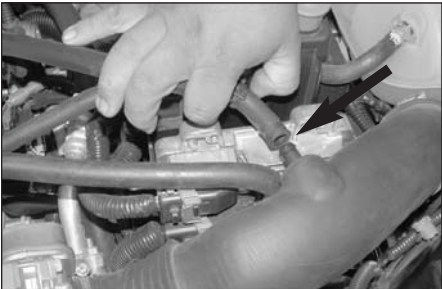

2. Remove the crankcase vent hose from stock intake tube as shown.



3. Loosen the two intake tube hose clamps and remove intake tube from vehicle as shown.



4. Jack the vehicle up and support with jack stand, then remove tire as shown.

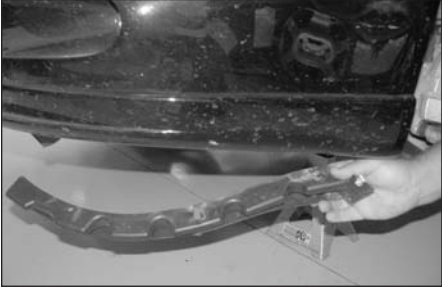

5. From underneath the vehicle, remove the push pins that secure the front lip support.



6. Remove the push clips that secure the inner fender well valance.



7. Pull the valance over the brake rotor to make some working room.

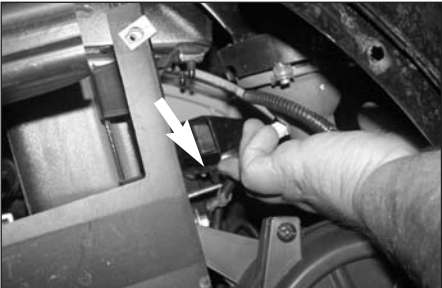

8. From underneath the vehicle, remove the electrical harness support clip.



9. Remove the three bolts that secure the lower air box.



10. Disconnect the mass air sensor electrical connection from lower air box then remove the lower air box from vehicle.



11. Remove the mass air sensor from stock intake tube as shown.

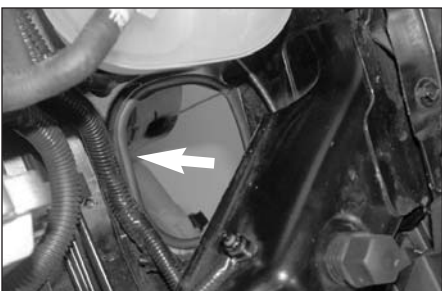

12. Measure, cut and install the provided edge trim to the hole in the fender well (top photo), then install another piece to edge of the fender well as shown. Trim to fit if necessary.

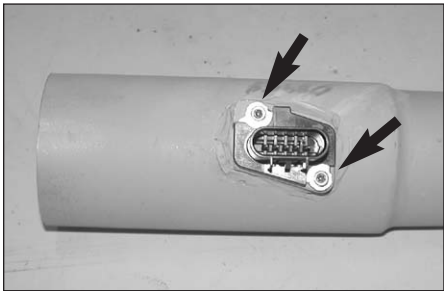

13. Install the mass air sensor onto the K&N intake tube and secure with the provided hardware.



14. Install the provided rubber mounted stud onto the K&N intake tube as shown.



15. Install the provided bracket onto the rubber mounted stud with the provided washer and bolt.

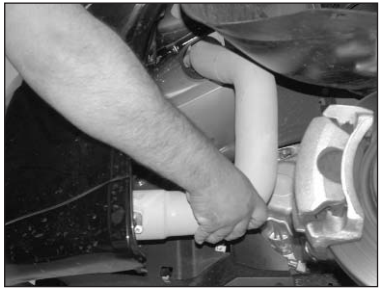

16. From underneath the vehicle, slide the K&N intake tube up and through the hole in the fender well.

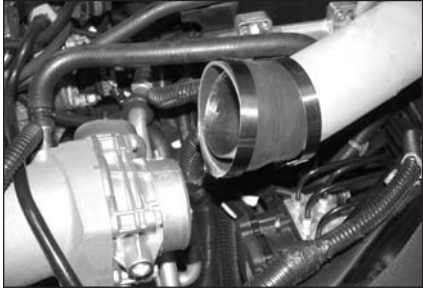

17. Install the silicone hose and provided hose clamps onto the K&N intake tube as shown.

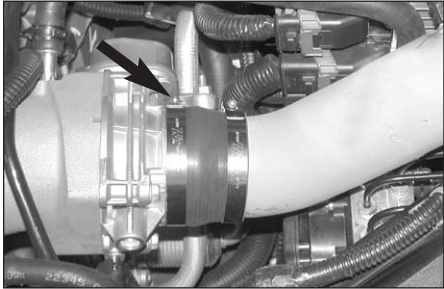

18. Slide the silicone hose over the throttle body and secure the hose clamp over the throttle body at this time.

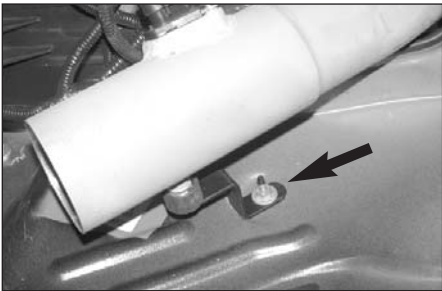

19. From underneath the vehicle, secure the "Z" bracket onto the stock air box mounting hole with the bolt removed in step 9.

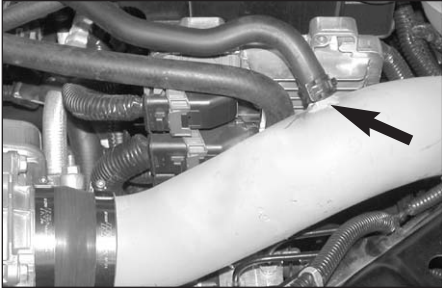

20. Reconnect the crankcase vent hose onto the K&N intake tube.

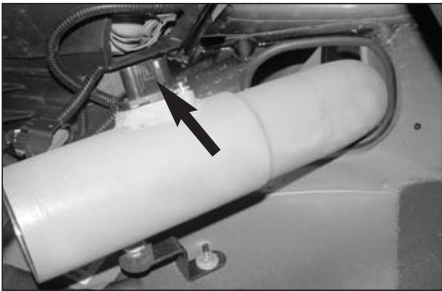

21. Reconnect the mass air sensor onto the K&N intake tube as shown.



22. Install the K&N Drycharger on the the K&N filter.

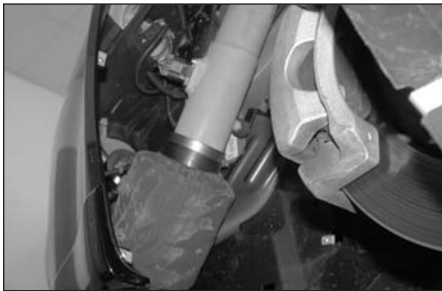

23. Install the K&N air filter onto the intake tube and secure it with the provided hose clamp as shown.

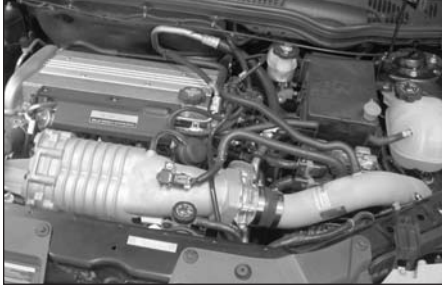

24. Reconnect the vehicle's negative battery cable. Double check to make sure everything is tight and properly positioned before starting the vehicle.

25. It will be necessary for all Typhoons to be checked periodically for realignment, clearance and tightening of all connections. Failure to follow the above instructions or proper maintenance may void warranty.

ROAD TESTING:

1. Start the engine with the transmission in neutral or park, and the parking brake engaged. Listen for air leaks or odd noises. For air leaks secure hoses and connections. For odd noises, find cause and repair before proceeding. This kit will function identically to the factory system except for being louder and much more responsive.

2. Test drive the vehicle. Listen for odd noises or rattles and fix as necessary.

3. If road test is fine, you can now enjoy the added power and performance from your kit.

4. K&N suggests checking the Filtercharger element periodically for excessive dirt build-up. When the element becomes covered in dirt (or once a year), service it according to the instructions on the Recharger service kit, part number 99-5050 or 99-5000.